

# Section

DO NOT SCALE

## Notes

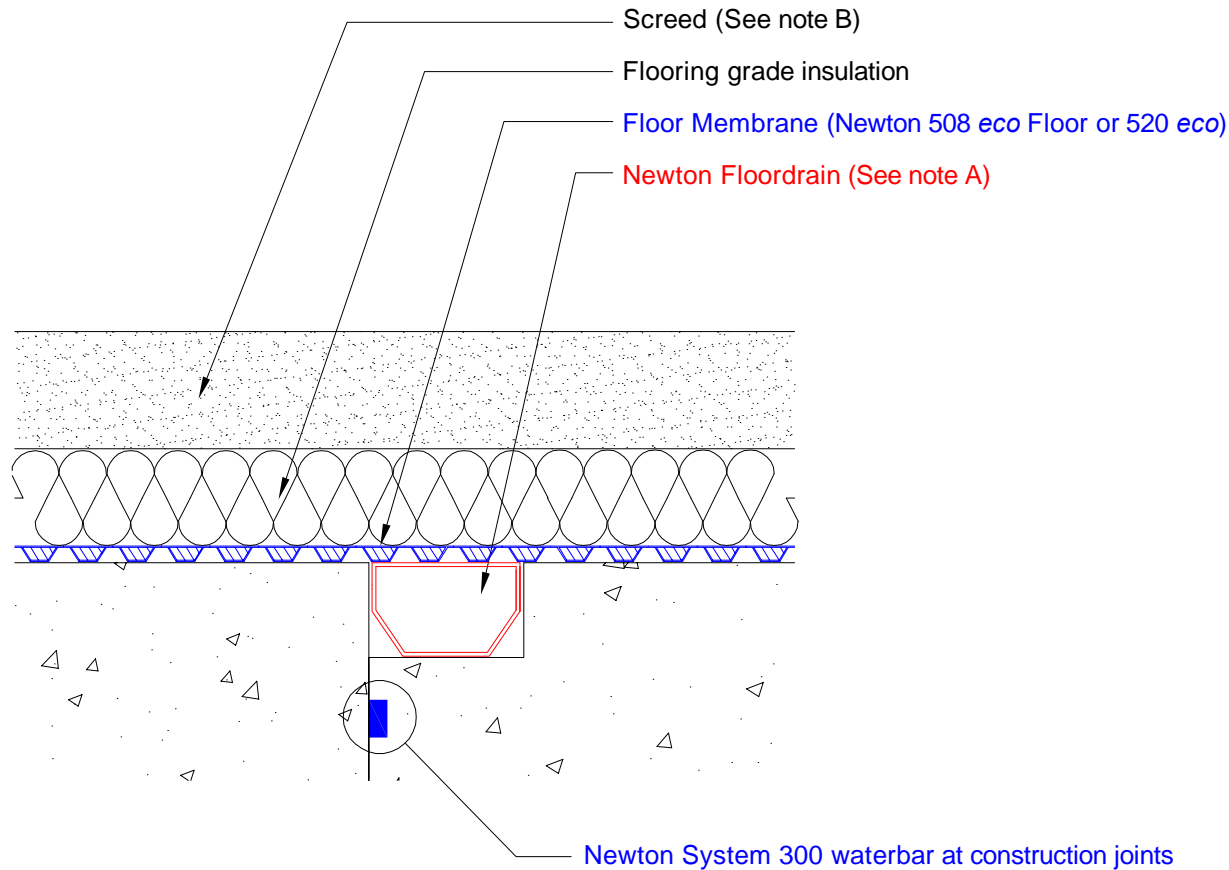

This detail shows protection to construction joints within the slab or raft with a line of Newton Floordrain. Use in conjunction with Newton drawings starting CDM-SW or CDM-RW where the Newton Basedrain is sat within a recess to the slab or raft. If the Newton Basedrain is laid above the slab as with drawings starting CDM-SA or CDM-RA, detail CDM-D01 should be used.

The Newton Floordrain connects to the perimeter Newton Basedrain ring with Newton Basedrain 'T' Pieces - see detail CDM-P03 Newton Basedrain Layout & Parts for further details.

A) Newton Floordrain should always be laid level and connected to the sump chamber or safe gravity drainage with at least two Drainage Connectors, see drawings CDM-P03 (Basedrain Layout & Parts) and CDM-P09 (Titan-Pro Pump System).

B) Screed to manufacturers recommendations or current British Standard.

To access further details and relevant technical information please call our Technical Team on 01732 360095 or refer to our [website](#).

Newton CDM System

Newton Floordrain channel within construction joint

NOTE: This is a Newton waterproofing detail and copyright remains with John Newton & Co. Ltd. (trading as Newton Waterproofing Systems). Any specification/advice provided is only valid if used with products supplied by John Newton & Co. Ltd. For the design of the structure, please use a professional designer. We recommend that Newtons' waterproofing systems are installed by our NSBC registered contractors who can offer insurance backed guarantees and accept liability for both the design and installation of our systems. Please refer to product data sheets before installation of our products. Newton Waterproofing Systems reserve the right to update drawings and product literature at any time.