

Section

DO NOT SCALE

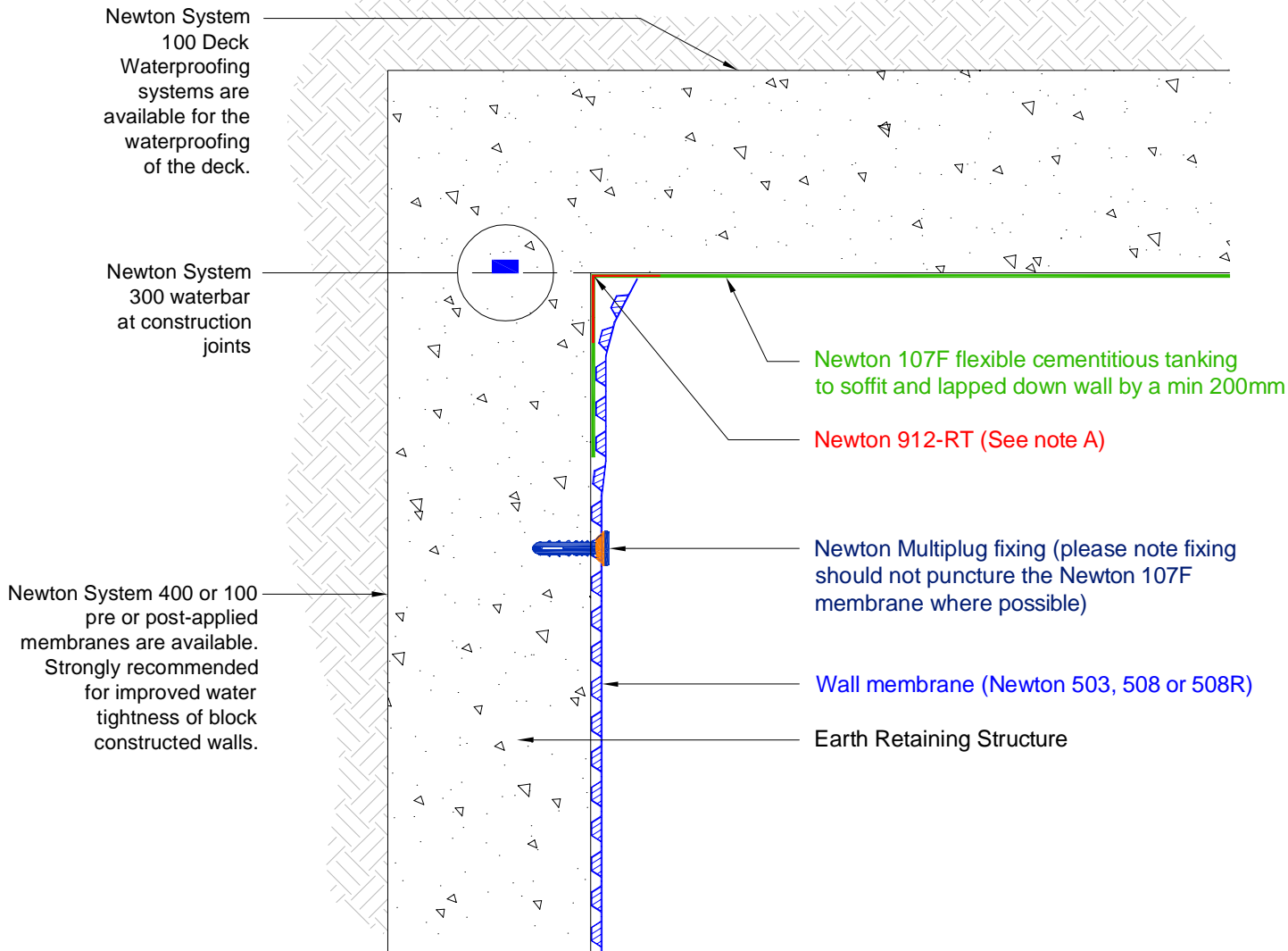

Notes			
This detail should be used in conjunction with a Newton CDM System waterproofing drawing.			
A) Reinforce the Wall/Soffit junction with Newton 912-RT. Please see Drawing CW-D01 for further information.			
If severe movement or vibration is expected please use detail CDM-D10B.			
To access further details and relevant technical information please call our Technical Team on 01732 360095 or refer to our website .			

Newton CDM System			
Internal Wall/Soffit junction of an Earth retaining structure - Newton System 500 Wall membranes to walls and Newton 107F tanking membrane to soffit			

NOTE: This is a Newton waterproofing detail and copyright remains with John Newton & Co. Ltd. (trading as Newton Waterproofing Systems). Any specification/advice provided is only valid if used with products supplied by John Newton & Co. Ltd. For the design of the structure, please use a professional designer. We recommend that Newtons' waterproofing systems are installed by our NSBC registered contractors who can offer insurance backed guarantees and accept liability for both the design and installation of our systems. Please refer to product data sheets before installation of our products. Newton Waterproofing Systems reserve the right to update drawings and product literature at any time.



© Newton Waterproofing Systems
 (a trading name of John Newton & Co. Ltd.)
 Newton House, 17 - 20 Sovereign Way, Tonbridge, Kent, TN9 1RH
 T: 01732 360095 W: www.newtonwaterproofing.co.uk E: tech@newtonwaterproofing.co.uk

Scale	Drawing Reference	Original Reference	Drawing Revision
Not to scale	CDM-D10A	D43	f
Date	Designed by	Drawn by	Checked by
20/03/2018	DGB	CER	DGB