

Section

DO NOT SCALE

Notes

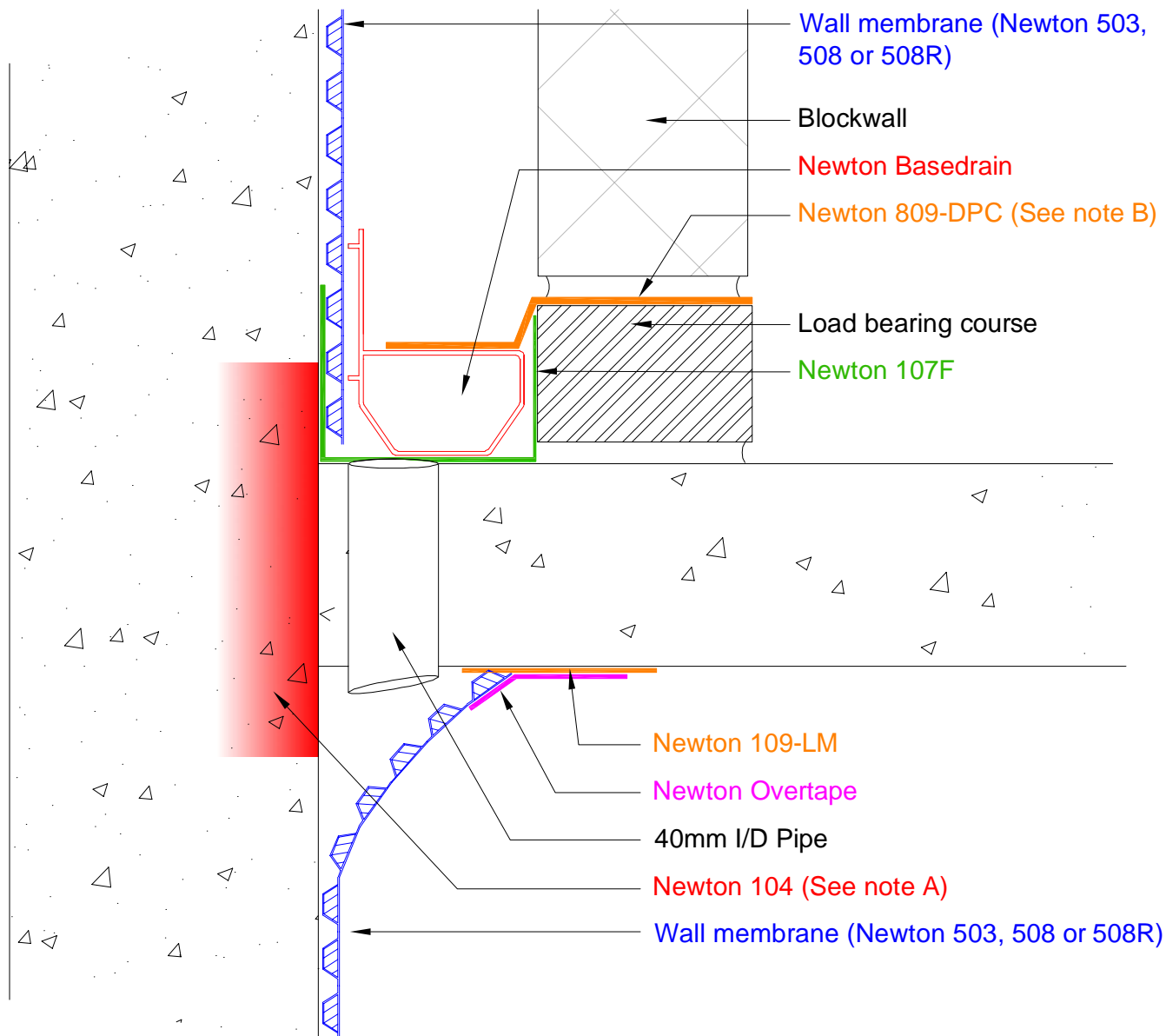

This detail shows a method of draining water through an abutting intermediate slab so that it can be received by the the Newton Waterproofing System at the lowest level of the basement.

It requires that a recess be formed with an engineering brick to act as a drainage channel. The recess is drained by 40mm I/D plastic pipes at 5m centres. Water draining via the pipes is collected by a coving detail of Newton 508 Wall membrane. There should be a minimum of two pipe penetrations on every run.

The recess should be coated with Newton 107F waterproof coating so that dampness cannot migrate from the recess to the slab. The membrane should be reinforced at the change in direction from horizontal to vertical with Newton 912-RT as recommended within the product data sheet.

Use in conjunction with a Newton CDM System drawing prefixed CDM that will show the detailing at the lower raft/slab level.

A) Newton 104 is applied to the surface of the wall prior to the placement of the slab to prevent moisture transmitting to the slab from the wall by capillary. Not applicable for remedial installation of the waterproofing. Not required if capillary blocking additive is added to the concrete prior to placement.

B) i) Newton 809-DPC is taped to Newton Floor membrane with Newton Waterseal Tape - not shown.
ii) Take the Newton 809-DPC across onto the top of the basedrain within the cavity as shown - (option).

To access further details and relevant technical information please call our Technical Team on 01732 360095 or refer to our [website](#).

Newton CDM System

Pipe through intermediate slab to allow draining of the Newton CDM System to lower level

NOTE: This is a Newton waterproofing detail and copyright remains with John Newton & Co. Ltd. (trading as Newton Waterproofing Systems). Any specification/advice provided is only valid if used with products supplied by John Newton & Co. Ltd. For the design of the structure, please use a professional designer. We recommend that Newtons' waterproofing systems are installed by our NSBC registered contractors who can offer insurance backed guarantees and accept liability for both the design and installation of our systems. Please refer to product data sheets before installation of our products. Newton Waterproofing Systems reserve the right to update drawings and product literature at any time.