

DO NOT SCALE

Notes

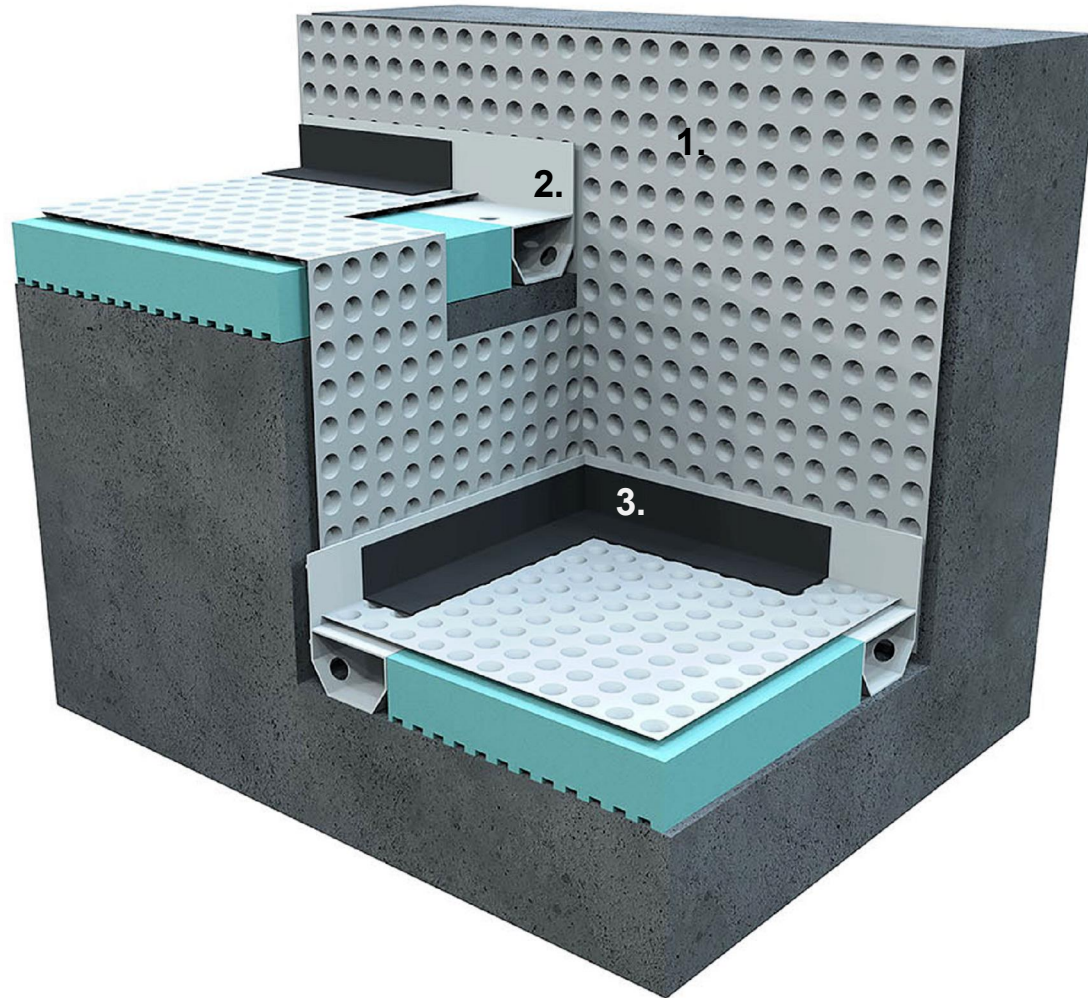

This detail shows how to fit the Newton CDM System to a change in floor levels where the Newton Basedrain is sat above the concrete slab/raft.

Water from the higher Newton Basedrain channel pours into the cavity formed by the Newton System 500 Wall membrane to the upstand between the two floor levels. The water then drains down to the lower Newton Basedrain ring and eventually into the sump or safe natural drainage.

1. Newton System 500 Wall membrane

2. Newton Basedrain

3. Newton Overtape

To access further details and relevant technical information please call our Technical Team on 01732 360095 or refer to our [website](#).

Newton CDM System

Newton Basedrain above slab/raft change in level

NOTE: This is a Newton waterproofing detail and copyright remains with John Newton & Co. Ltd. (trading as Newton Waterproofing Systems). Any specification/advice provided is only valid if used with products supplied by John Newton & Co. Ltd. For the design of the structure, please use a professional designer. We recommend that Newtons' waterproofing systems are installed by our NSBC registered contractors who can offer insurance backed guarantees and accept liability for both the design and installation of our systems. Please refer to product data sheets before installation of our products. Newton Waterproofing Systems reserve the right to update drawings and product literature at any time.

Scale Not to scale	Drawing Reference CDM-D21A-3D	Original Reference	Drawing Revision d
Date 20/03/2018	Designed by DGB	Drawn by CER	Checked by DGB