

Section

DO NOT SCALE

Notes

Sealing to protrusions through the Newton System 500 Wall membrane is a simple task because the system is not pressure resistant, as is the case with tanking, and the Newton System 500 Wall membrane is not holding back water pressure. This means the repair around the protrusion is only required to prevent the movement of moisture vapour, and so is much easier to effect.

To access further details and relevant technical information please call our Technical Team on 01732 360095 or refer to our [website](#).

Newton CDM System
 Fixing through the Newton System 500 Wall membrane showing options using the Newton MultiPlug or a stronger resin anchor fixing

1.

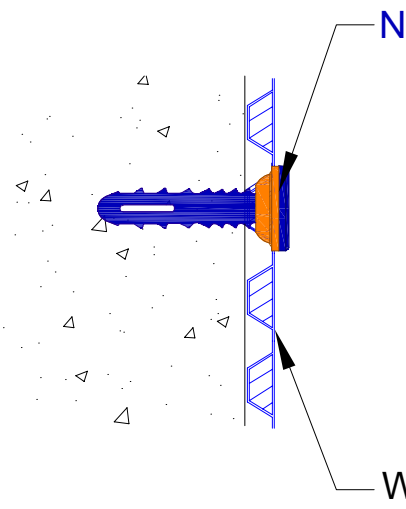

Newton MultiPlug

Where possible, fixings to Newton System 500 should be facilitated by using the Newton MultiPlug. The plug has a hole within the shank to receive 'Size 10' screws. A number of plugs can be used to create a backing or frame where heavier or larger items are to be fixed.

Please note that the 'pull strength' of the plug varies depending on the substrate the plug is fixed into.

Wall Membrane (Newton 508/508R shown)

2.

Where stronger fixing is required, proprietary fixing systems such as a stainless steel resin anchor system or similar can be used.

It is important to seal around the protrusion through the Newton Wall membrane with Newton Mastic, or with a bead of Newton Waterseal Rope. With both methods it is advisable to use sufficient sealing product so that the seal is formed both in front and behind the membrane so as to plug the membrane on the wet side also.

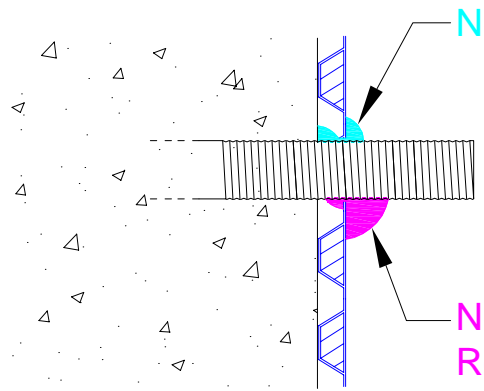

Newton Mastic

Newton Waterseal Rope

NOTE: This is a Newton waterproofing detail and copyright remains with John Newton & Co. Ltd. (trading as Newton Waterproofing Systems). Any specification/advice provided is only valid if used with products supplied by John Newton & Co. Ltd. For the design of the structure, please use a professional designer. We recommend that Newtons' waterproofing systems are installed by our NSBC registered contractors who can offer insurance backed guarantees and accept liability for both the design and installation of our systems. Please refer to product data sheets before installation of our products. Newton Waterproofing Systems reserve the right to update drawings and product literature at any time.

Scale Not to scale	Drawing Reference CDM-D26	Original Reference D30	Drawing Revision c
Date 20/03/2018	Designed by	Drawn by CER	Checked by DGB