

Section

DO NOT SCALE

Notes

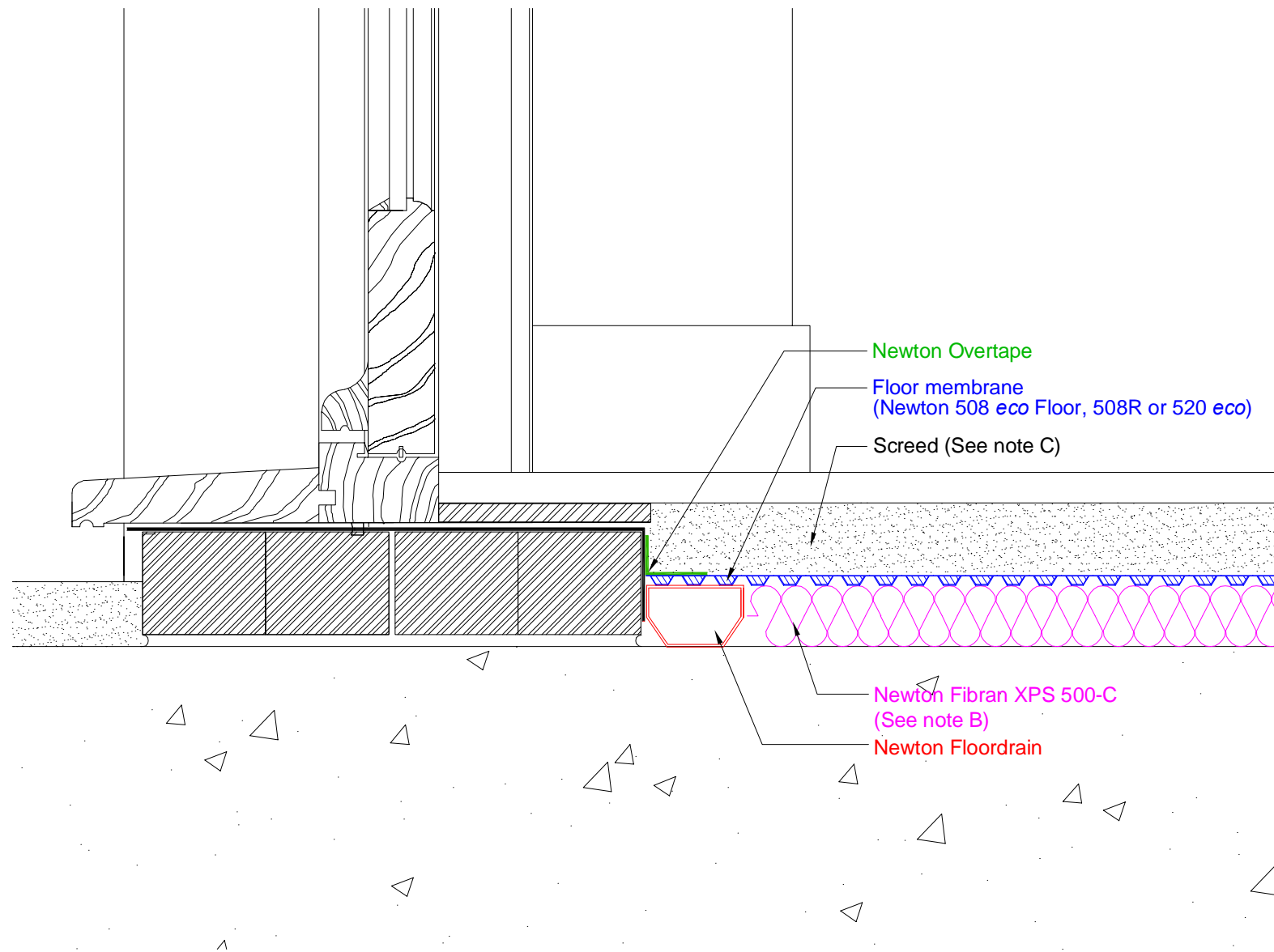

Newton Overtape

Floor membrane
(Newton 508 eco Floor, 508R or 520 eco)

Screed (See note C)

Newton Fibran XPS 500-C
(See note B)

Newton Floordrain

This detail shows how the Newton CDM System is detailed at a threshold. Use in conjunction with Newton drawings starting CDM-SA or CDM-RA where the Newton Floordrain is laid above the slab. If the Newton Floordrain is sat within a recess to the slab or raft as with drawings starting CDM-SW or CDM RW, detail CDM-D48B should be used.

A) Newton Floordrain should always be laid level and connected to the sump chamber or safe gravity drainage with at least two Drainage Connectors, see drawings CDM-P03 (Basedrain Layout & Parts) and CDM-P09 (Titan-Pro Pump System).

B) Newton Fibran XPS 500-C is placed below the Newton flooring membrane as a fully drained supporting spacer. The maximum floor load is 16 Mpa (1.6 tonnes/m²). Newton Fibran XPS 500-C has a thermal conductivity of 0.035W/mk and as such will make a significant contribution to the U-value of the floor.

C) Screed to manufacturers recommendations or current British Standard.

To access further details and relevant technical information please call our Technical Team on 01732 360095 or refer to our [website](#).

Newton CDM System

Threshold detail

NOTE: This is a Newton waterproofing detail and copyright remains with John Newton & Co. Ltd. (trading as Newton Waterproofing Systems). Any specification/advice provided is only valid if used with products supplied by John Newton & Co. Ltd. For the design of the structure, please use a professional designer. We recommend that Newtons' waterproofing systems are installed by our NSBC registered contractors who can offer insurance backed guarantees and accept liability for both the design and installation of our systems. Please refer to product data sheets before installation of our products. Newton Waterproofing Systems reserve the right to update drawings and product literature at any time.

| | | | |
|-----------------------|-------------------------------|--------------------|-----------------------|
| Scale Not to scale | Drawing Reference CDM-D48A | Original Reference | Drawing Revision d |
| Date 20/03/2018 | Designed by DGB | Drawn by AJG | Checked by DGB |