

# Section

DO NOT SCALE

## Notes

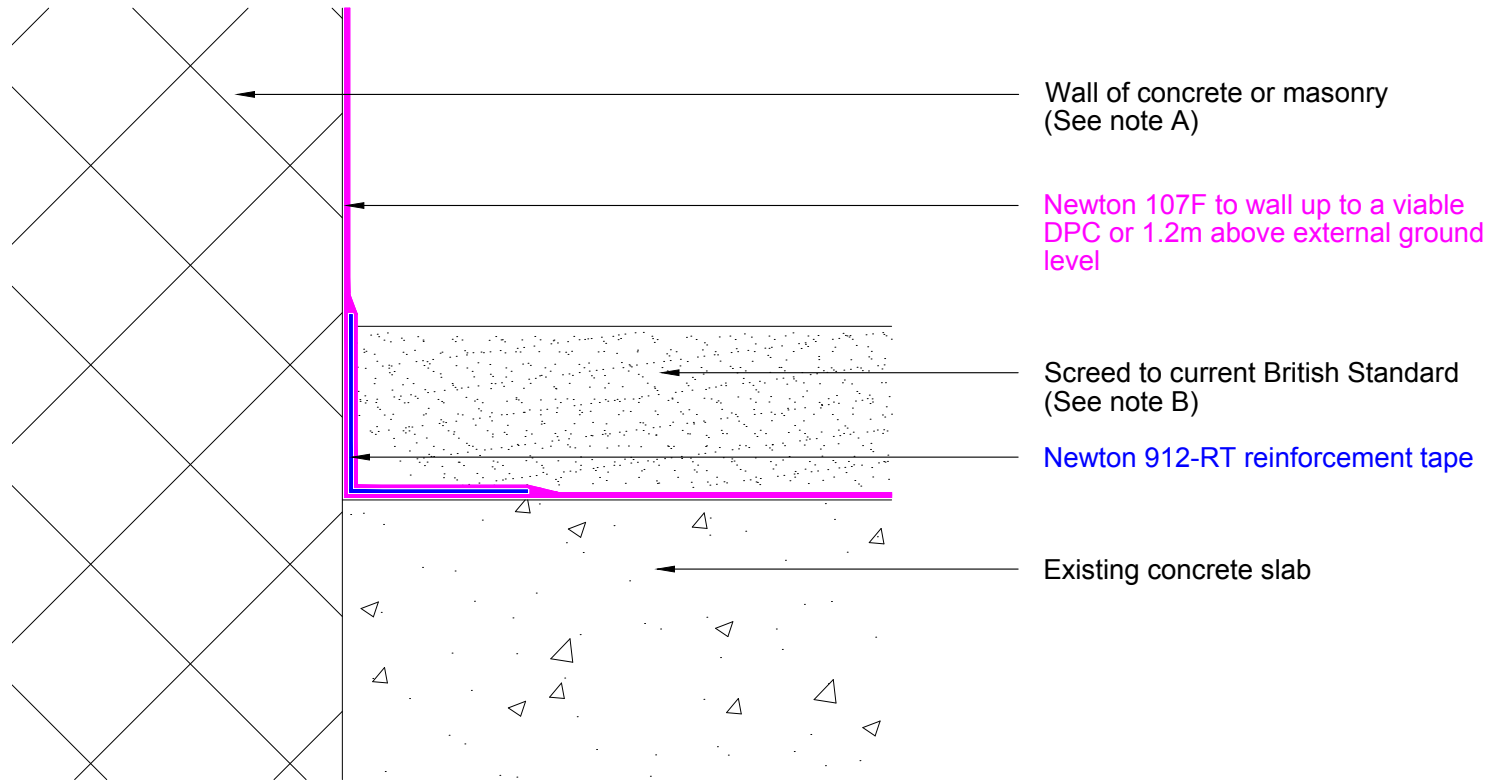

Wall of concrete or masonry  
(See note A)

Newton 107F to wall up to a viable  
DPC or 1.2m above external ground  
level

Screed to current British Standard  
(See note B)

Newton 912-RT reinforcement tape

Existing concrete slab

This detail shows the reinforcement of Newton 107F at the change in direction at the wall/floor joint.

Newton 107F is a highly flexible cement based waterproofing slurry.

Newton 912-RT reinforcement tape is bedded into the first coat of Newton 107F.

A) This detail can be used for wall constructions of concrete, brick and block. For block and brick construction, the substrate should be smoothed with a 10mm thick smoothing coat of 3:1 sand/cement mixed with Newton 908 LiquaBond.

B) Newton 107F requires protecting with a wearing coat of screed or similar.

Please note, this detail will only accommodate minor movement between wall and slab.

To access further details and relevant technical information please call our Technical Team on 01732 360095 or refer to our [website](#).

Newton HydroSeal System

Wall floor junction - Type A - 107F - 912-RT

NOTE: This is a Newton waterproofing detail and copyright remains with John Newton & Co. Ltd. (trading as Newton Waterproofing Systems). Any specification/advice provided is only valid if used with products supplied by John Newton & Co. Ltd. For the design of the structure, please use a professional designer. We recommend that Newtons' waterproofing systems are installed by our NSBC registered contractors who can offer insurance backed guarantees and accept liability for both the design and installation of our systems. Please refer to product data sheets before installation of our products. Newton Waterproofing Systems reserve the right to update drawings and product literature at any time.

Scale	Drawing Reference	Original Reference	Drawing Revision
Not to scale	CW-D01		C
Date	Designed by	Drawn by	Checked by
13/06/2017	DGB	AJG	DGB