

Plan or Section

DO NOT SCALE

Notes

This drawing shows a method of fixing points through a concrete substrate waterproofed with Newton 107F.

Fixing directly to the wall, through the waterproof coating, will breach the membrane. Lap the Newton 107F on to the resin anchor for continuity of the waterproofing.

Drill appropriate sized hole as required; blow out all debris and then insert resin capsule followed by anchor bolt as per manufacturers instructions.

To access further details and relevant technical information please call our Technical Team on 01732 360095 or refer to our [website](#).

Newton HydroSeal System

Fixing point - 107F - 908 LiguaBond/
203-RM

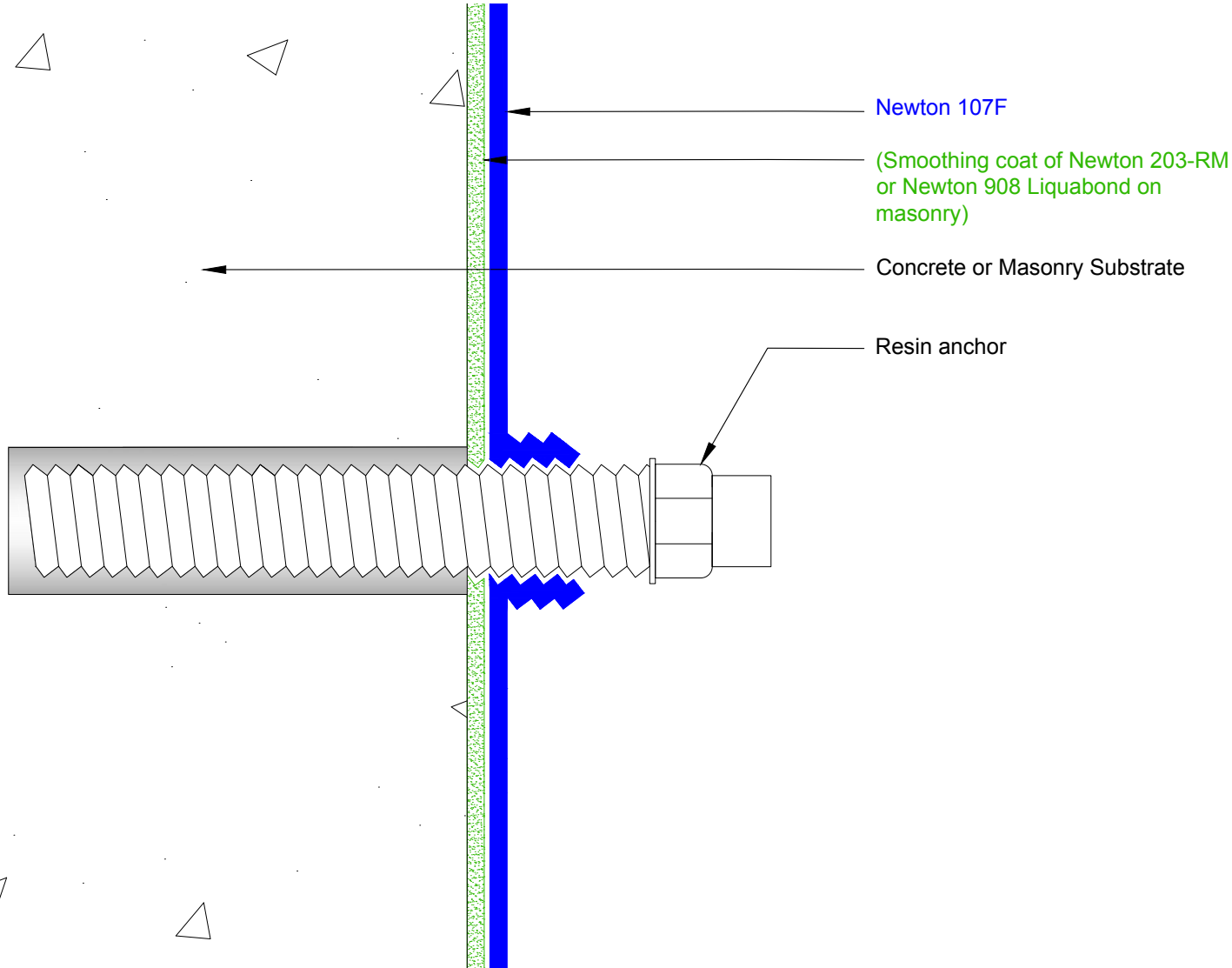

NOTE: This is a Newton waterproofing detail and copyright remains with John Newton & Co. Ltd. (trading as Newton Waterproofing Systems). Any specification/advice provided is only valid if used with products supplied by John Newton & Co. Ltd. For the design of the structure, please use a professional designer. We recommend that Newtons' waterproofing systems are installed by our NSBC registered contractors who can offer insurance backed guarantees and accept liability for both the design and installation of our systems. Please refer to product data sheets before installation of our products. Newton Waterproofing Systems reserve the right to update drawings and product literature at any time.

| | | | |
|-----------------------|------------------------------|--------------------|-----------------------|
| Scale Not to scale | Drawing Reference CW-D02C | Original Reference | Drawing Revision a |
| Date 06/06/2018 | Designed by DGB | Drawn by CER | Checked by DGB |