

Section

DO NOT SCALE

Notes

This drawing shows Newton 803 Newtonite or Newton 805 Newlath applied to the wall as a damp proofing solution.

Newton Mesh Plugs should be fixed at 250 - 300mm centres.

The wall membrane should be extended to just above a viable DPC or 100mm above the height of the recorded rising damp or salt band.

Please refer to plasterboard on dabs specification within the installation instructions of Newton Meshed membranes.

To access further details and relevant technical information please call our Technical Team on 01732 360095 or refer to our [website](#).

System 800 Damp Proofing

Meshed membrane with dot & dab finish into timber floor void

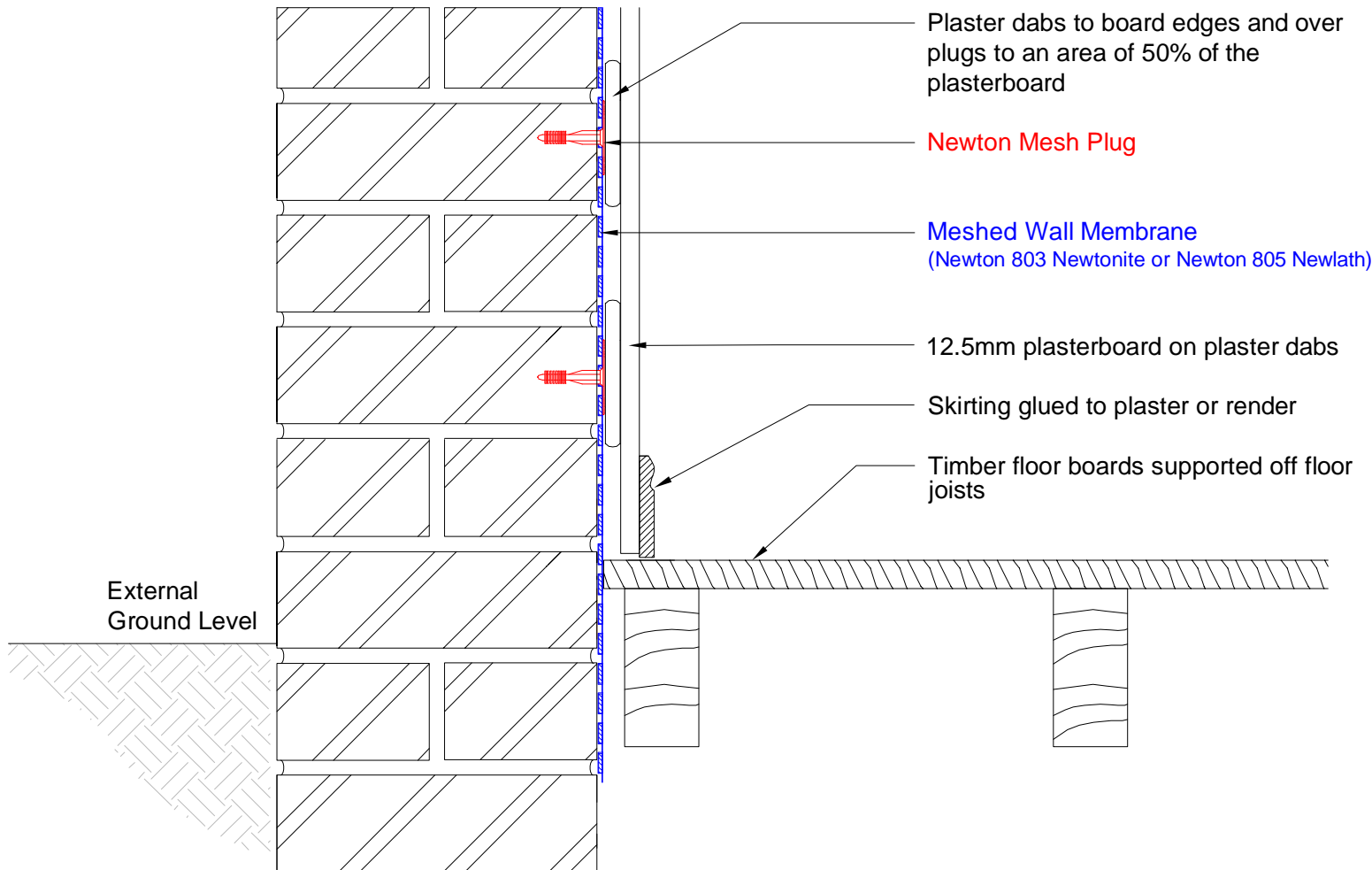

NOTE: This is a Newton damp proofing detail and copyright remains with John Newton & Co. Ltd. (trading as Newton Waterproofing Systems). Any specification/advice provided is only valid if used with products supplied by John Newton & Co. Ltd. For the design of the structure, please use a professional designer. Please refer to product data sheets before installation of our products. Newton Waterproofing Systems reserve the right to update drawings and product literature at any time.