

Section

DO NOT SCALE

Notes

This drawing shows Newton 803 Newtonite or Newton 805 Newlath applied to the wall as a damp proofing solution.

Newton Mesh Plugs should be fixed at 250 - 300mm centres.

The wall membrane should be extended to just above a viable DPC or 100mm above the height of the recorded rising damp or salt band.

Please refer to plasterboard on dabs specification within the installation instructions of Newton Meshed membranes.

To access the details mentioned above, relevant NBS Clauses, product data and MSDS sheets, please visit Technical resources via www.newtonwaterproofing.co.uk

System 800 Damp Proofing

Meshed membrane with dot & dab finish into timber floor void.

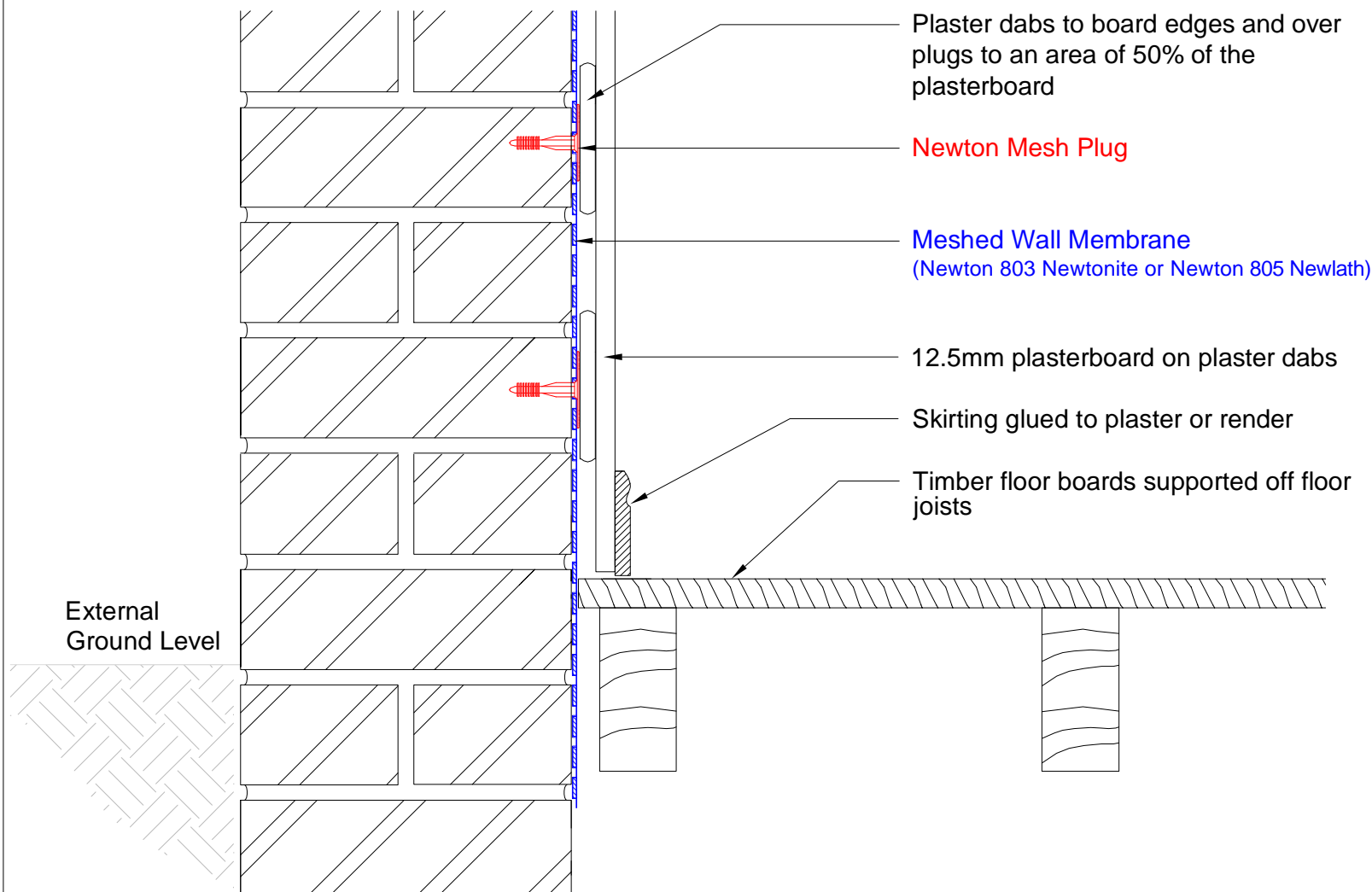

NOTE: This is a damp proofing detail. Please refer to product data sheets before installation of our products. Newton Waterproofing Systems reserves the right to update drawings.