

Section

DO NOT SCALE

Notes

This drawing shows Newton 803 Newtonite or Newton 805 Newlath to the wall as a damp proofing solution.

Newton Mesh plugs should be fixed at 250 - 300mm centers.

The wall membrane should be extended to just above a viable DPC or 100mm above the height of the recorded rising damp or salt band.

Please refer to plastering and rendering specifications within the installation instructions of Newton Meshed Membranes.

Please refer to drawing ref DP-08, DP-06A&B for confirmation of the detailing for the protection of the joist ends.

To access further details and relevant technical information please call our Technical Team on 01732 360095 or refer to our [website](#).

System 800 Damp Proofing

Mesh membrane with plaster finish into timber floor void

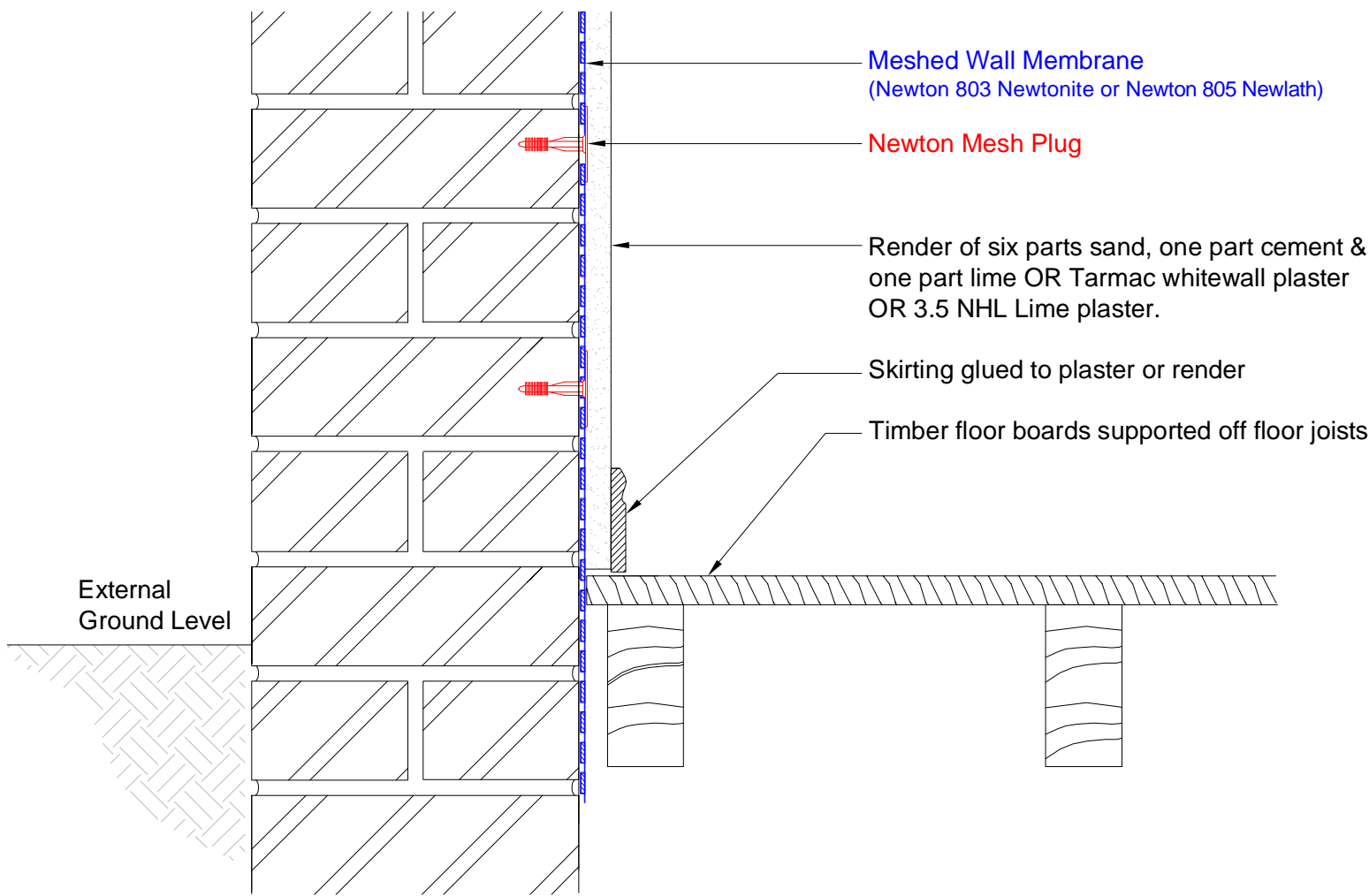

NOTE: This is a Newton damp proofing detail and copyright remains with John Newton & Co. Ltd. (trading as Newton Waterproofing Systems). Any specification/advice provided is only valid if used with products supplied by John Newton & Co. Ltd. For the design of the structure, please use a professional designer. Please refer to product data sheets before installation of our products. Newton Waterproofing Systems reserve the right to update drawings and product literature at any time.

Scale	Drawing Reference	Original Reference	Drawing Revision
Not to scale	DP-02D	DP-101	c
Date	Designed by	Drawn by	Checked by
04/10/2017	DGB	CER	DGB