

Section

DO NOT SCALE

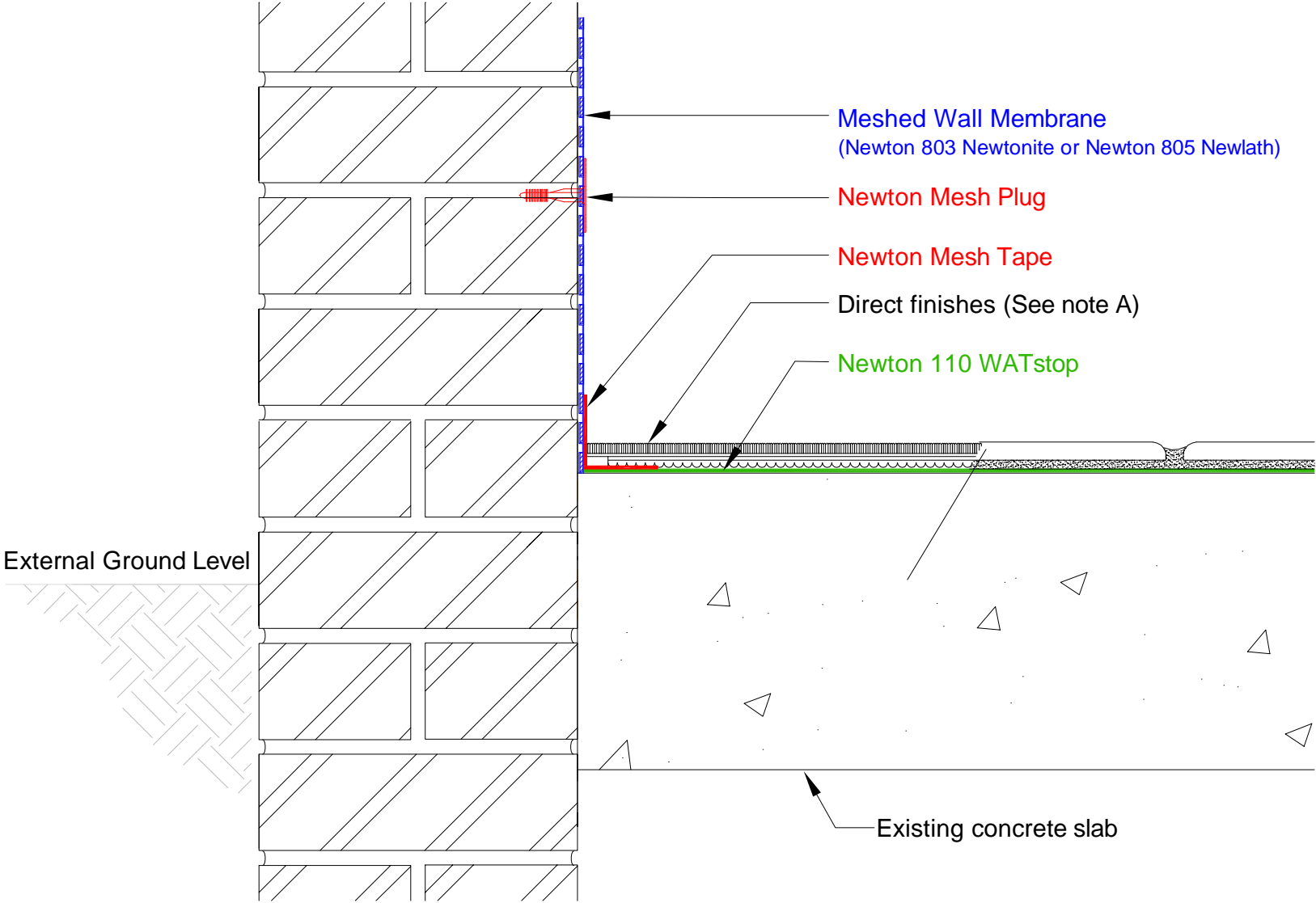

Notes

This drawing shows Newton 803 Newtonite or Newton 805 Newlath to the wall as a damp proofing membrane to an above ground elevation.

Newton Mesh Plugs should be fixed at 250 - 300mm centers.

The wall membrane should be extended to just above a viable DPC or 100mm above the height of the recorded rising damp or salt band.

Please refer to plastering and rendering specifications within the installation instructions of Newton Meshed Membranes.

A) Carpet gripper rods can be adhered directly to the dry liquid applied membrane using a non-solvent based adhesive. Alternatively tiles can be laid directly onto the dry liquid applied membrane.

To access the details mentioned above, relevant NBS Clauses, product data and MSDS sheets, please visit Technical resources via www.newtonwaterproofing.co.uk

System 800 Damp Proofing
Meshed membrane with plaster finish linking to a liquid applied floor damp proofing membrane

NOTE: This is a damp proofing detail. Please refer to product data sheets before installation of our products. Newton Waterproofing Systems reserves the right to update drawings.

Scale Not to scale	Drawing Reference DP-04	Original Reference	Drawing Revision C
Date 04/10/2017	Designed by AS/DGB	Drawn by AJG/RAC	Checked by DGB