

Section

DO NOT SCALE

Notes

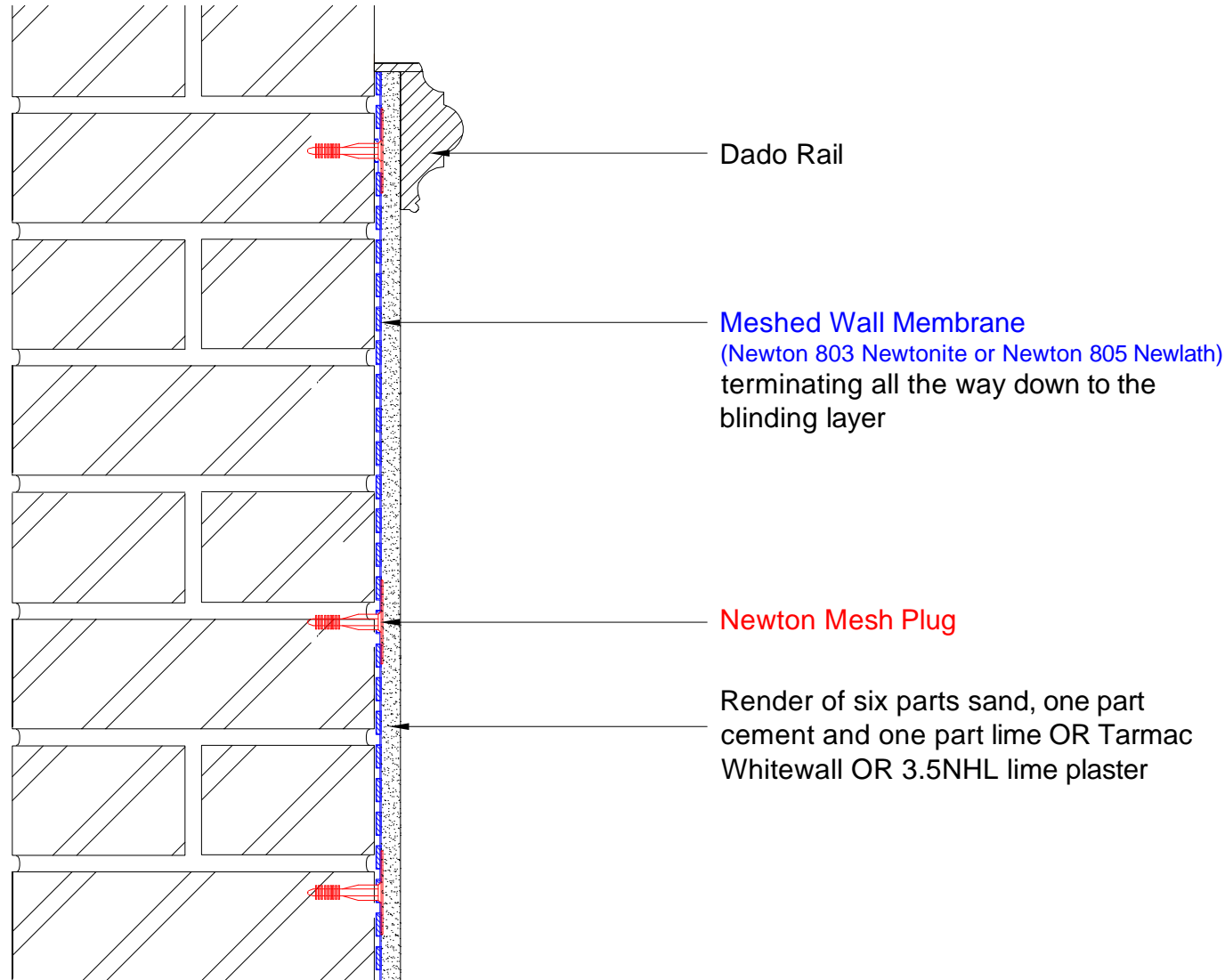

This detail shows either Newton 803 Newtonite or Newton 805 Newlath to a wall as a damp proofing solution finished using a dado rail.

The wall membrane should be extended to just above a viable DPC or 100mm above the height of the recorded rising damp or salt band.

Please refer to plastering and rendering specifications within the installation instruction of Newton Meshed membranes.

Newton Mesh Plugs should be fixed at 250-300mm centres.

To access the details mentioned above, relevant NBS Clauses, product data and MSDS sheets, please visit Technical resources via www.newtonwaterproofing.co.uk

System 800 Damp Proofing

Typical damp proofing finishing detail using dado rail

NOTE: This is a damp proofing detail. Please refer to product data sheets before installation of our products. Newton Waterproofing Systems reserves the right to update drawings.

Scale Not to scale	Drawing Reference DP-D01	Original Reference	Drawing Revision C
Date 04/10/2017	Designed by AJG	Drawn by AJG/RAC	Checked by DGB