

Section

DO NOT SCALE

Notes

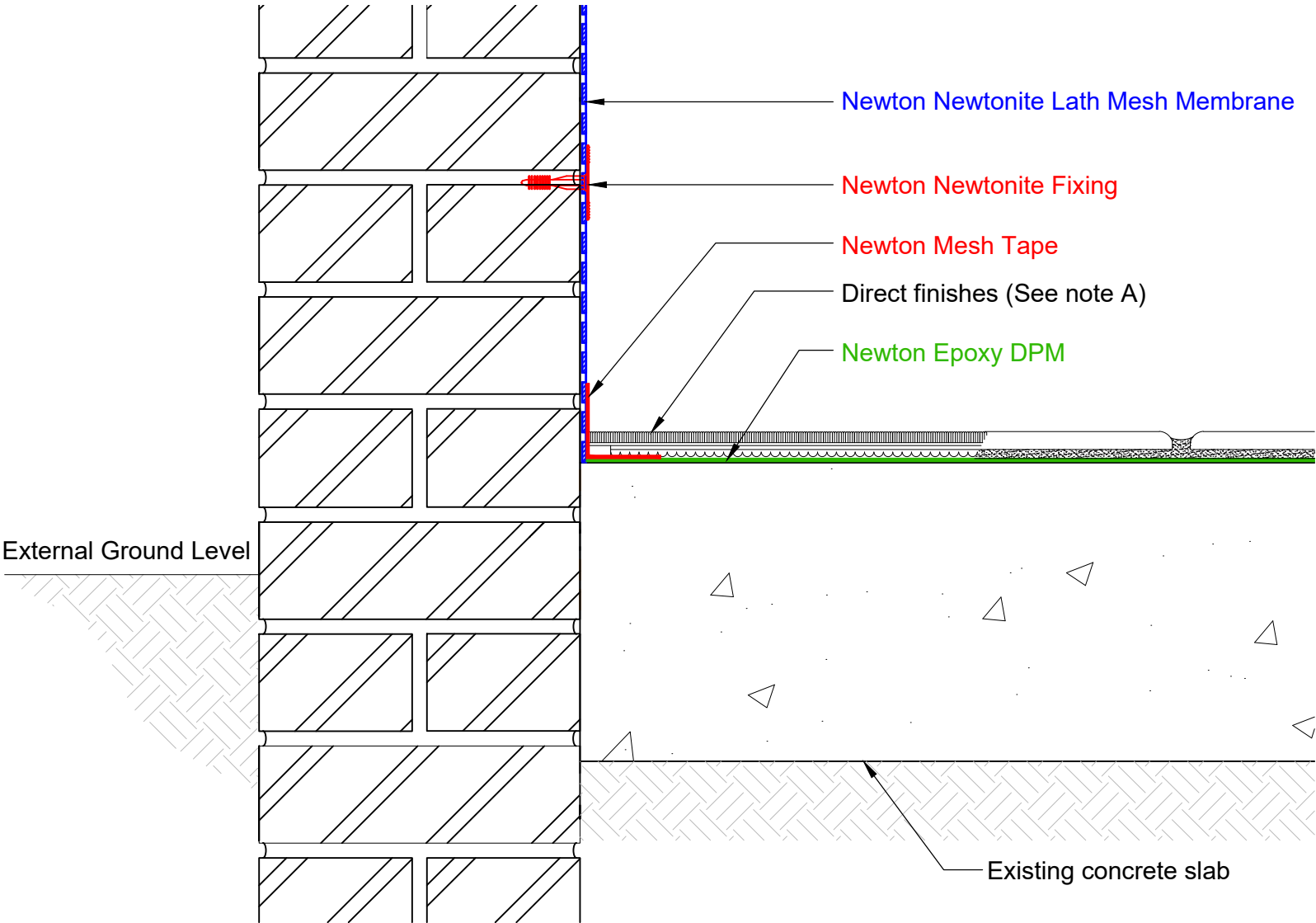

This drawing shows the Newton Newtonite System to the wall as a damp proofing membrane to an above ground elevation.

Newton Newtonite Fixings should be fixed at 250 - 300mm centers.

The wall membrane should be extended to just above a viable DPC or 100mm above the height of the recorded rising damp or salt band.

Please refer to plastering and rendering specifications within the installation instructions of Newton Meshed Membranes.

A) Carpet gripper rods can be adhered directly to the dry liquid applied membrane using a non-solvent based adhesive. Alternatively tiles can be laid directly onto the dry liquid applied membrane.

To access further details and relevant technical information please call our Technical Team on 01732 360 095 or refer to our [website](#).

NOTE: This is a Newton waterproofing detail and copyright remains with John Newton & Co. Ltd. (trading as Newton Waterproofing Systems). Any specification/advice provided is only valid if used with products supplied by John Newton & Co. Ltd. For the design of the structure, please use a professional designer. We recommend that Newtons' waterproofing systems are installed by our NSBC registered contractors who can offer insurance backed guarantees and accept liability for both the design and installation of our systems. Please refer to product data sheets before installation of our products. Newton Waterproofing Systems reserve the right to update drawings and product literature at any time.

Reference	DP-04	Designed	JRN
Revision	C	Drawn	PJN
Date	26/11/2024	Checked	TC