

SECTION

DO NOT SCALE

Notes

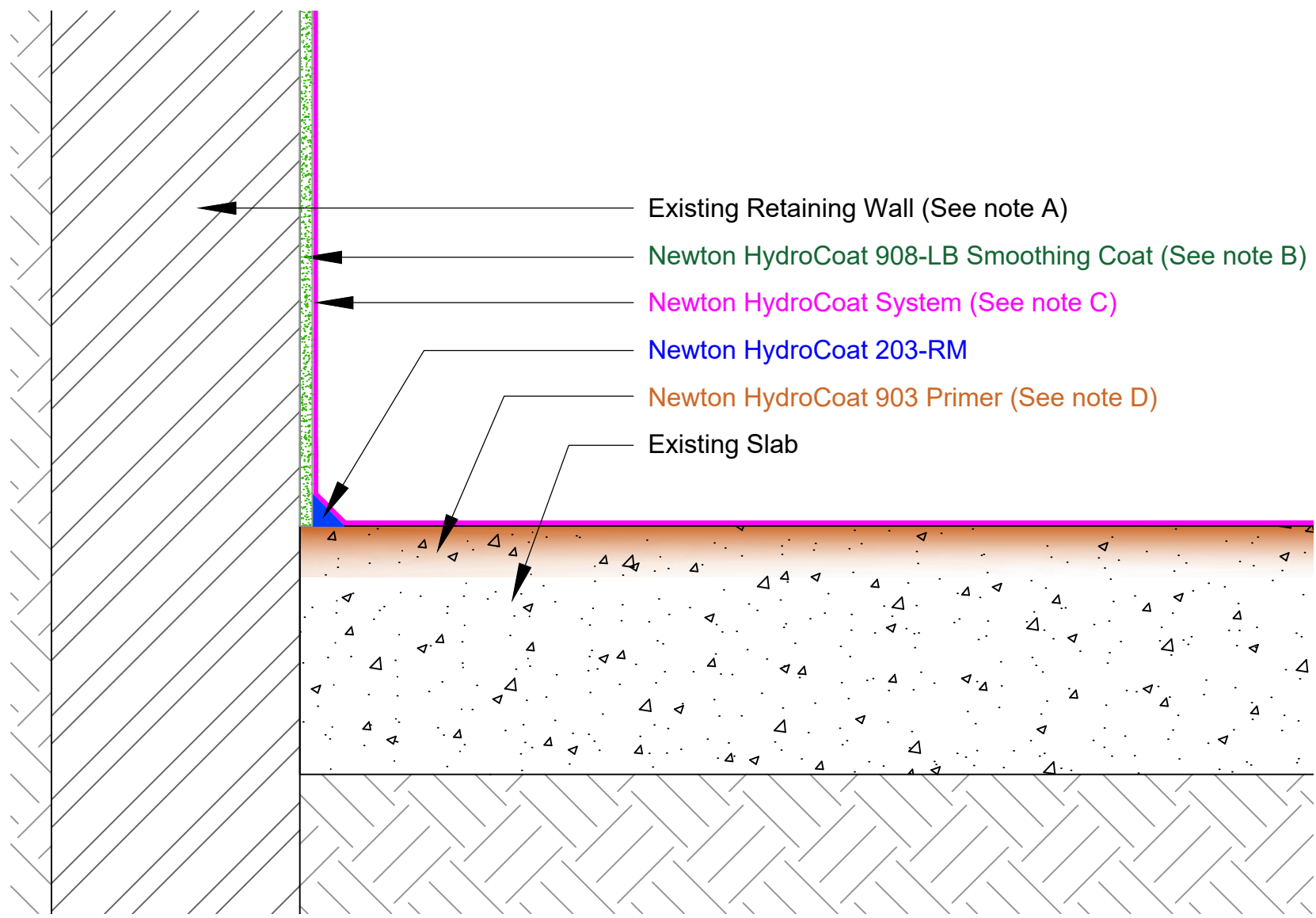

This detail assumes that the structure is in good condition - constructed to BS EN 1992 (Eurocode 2), and that the structure as a whole is of sufficient mass and quality to resist heads of water pressure as required by BS8102.

- A. For a rubble wall a stainless steel EML is plugged and screw fixed at 150mm centres to the random rubble wall and rendered to provide a suitably stable substrate to accept the Newton HydroCoat System.
- B. Newton HydroCoat 908-LB smoothing coat Render 3 parts sand, one part cement.
- C. Newton HydroCoat System applied to walls to 1.2m above external ground level or to a viable DPC. Internal 'Type A' membranes are often the products that are referred to when people talk about the process of "tanking" a basement to protect it from water. Waterproofing barrier membranes that can be applied to the internal 'negative' side of the structure include a variety of liquid-applied membranes or slurries that can be installed either by spray machine, trowel, brush, or by roller directly onto the internal wall surface.
- D. Newton HydroCoat 903 Primer is a modified styrene/acrylic copolymer primer.

All construction joints (day joints, shrinkage joints, movement joints etc) should be waterproofed with Newton HydroTank System waterbars to limit water ingress through joints in the structure.

Please note, this detail will only accommodate minor movement between wall and raft.

If a vapour barrier is required please refer to the Newton Technical Department.

This detail is intended as guidance only and provides an understanding of how the products and systems can be configured as part of a waterproofing strategy; and should not be understood as being the project waterproofing design or that Newton are fulfilling the role as appointed waterproofing designer as recommended by BS 8102:2022.

Newton or our delivery partners can fulfil the appointed role of waterproofing designer. Please speak to our Technical Team for further information.

To access further details and relevant technical information please call our Technical Team on 01732 360 095 or refer to our [website](#).

NOTE: This is a Newton waterproofing detail and copyright remains with John Newton & Co. Ltd. (trading as Newton Waterproofing Systems). Any specification/advice provided is only valid if used with products supplied by John Newton & Co. Ltd. For the design of the structure, please use a professional designer. We recommend that Newtons' waterproofing systems are installed by our NSBC registered contractors who can offer insurance backed guarantees and accept liability for both the design and installation of our systems. Please refer to product data sheets before installation of our products. Newton Waterproofing Systems reserve the right to update drawings and product literature at any time.

Reference	JN-HC-06A	Designed	DGB
Revision	B	Drawn	AJG
Date	26/09/2023	Checked	DB/TC