

Type A Waterproofing

A-12 SPECIFICATION SHEET

Internal Waterproofing of Underpinning

Rev 3.2 - 13 January 2025

BUILD

WALL CONSTRUCTION:

Underpinned existing structure

FLOOR CONSTRUCTION:

Reinforced Concrete (RC) Slab

NWI SCALE

Waterproofing solutions can only achieve environmental Grades 1a, 1b or 2.

Refer to page 5 of the Newton Design Philosophy.

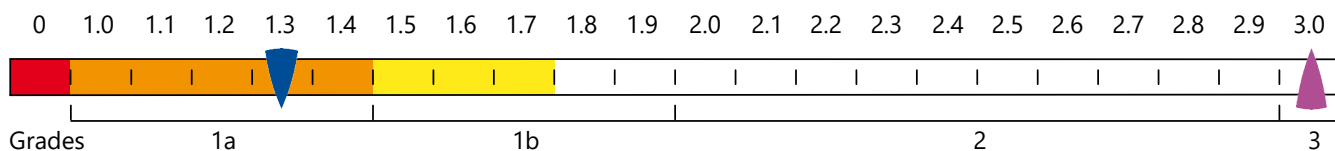

NWI Score when ventilation has not been included.

Ventilation, dehumidification or air conditioning is necessary; appropriate to intended use to achieve Grade 3 - BS 8102:2022.

This specification employs 1 form of waterproofing (Type A - Barrier Protection) to prevent ground water passing through the structural elements of the building to ensure that the desired internal environment is achieved. The success of the waterproofing is dependent on the Type A system being effective especially over the mortar joints of the block wall and the wall/slab junction.

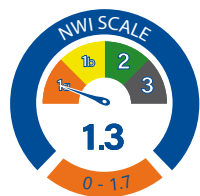

specifications. The NWI score is awarded by a panel of experienced waterproofing design specialists and reflects the chances of success of that specification. The scoring system works in conjunction with the British Standard for waterproofing, which defines the three types of internal environments as Grades 1a, 1b, 2 and 3.

SPECIFICATION

ANCILLARIES

Install appropriate Newton waterbars to all construction joints and service penetrations.

TYPE A APPLIED INTERNALLY

Waterproof the structure with [Newton HydroCoat System](#) providing barrier protection.

NEWTON WATERPROOFING INDEX

The Newton Waterproofing Index (NWI) is a unique scoring system that accurately assesses the level of risk and potential success of specific waterproofing

NOTES

To improve the NWI score please see Newton Specification Sheet AC-05.

The detailing of other building elements and termination details are available within the Newton Waterproofing specification library.

A-RATED INSURANCE

Tailor made insurance policies available depending on the specialist contractor and specification.

Any specification/advice provided is only valid if used with products supplied by John Newton and Company Ltd (trading as Newton Waterproofing Systems). Newton Waterproofing Systems reserve the right to update product literature at any time. Please always refer to our website for the latest versions.

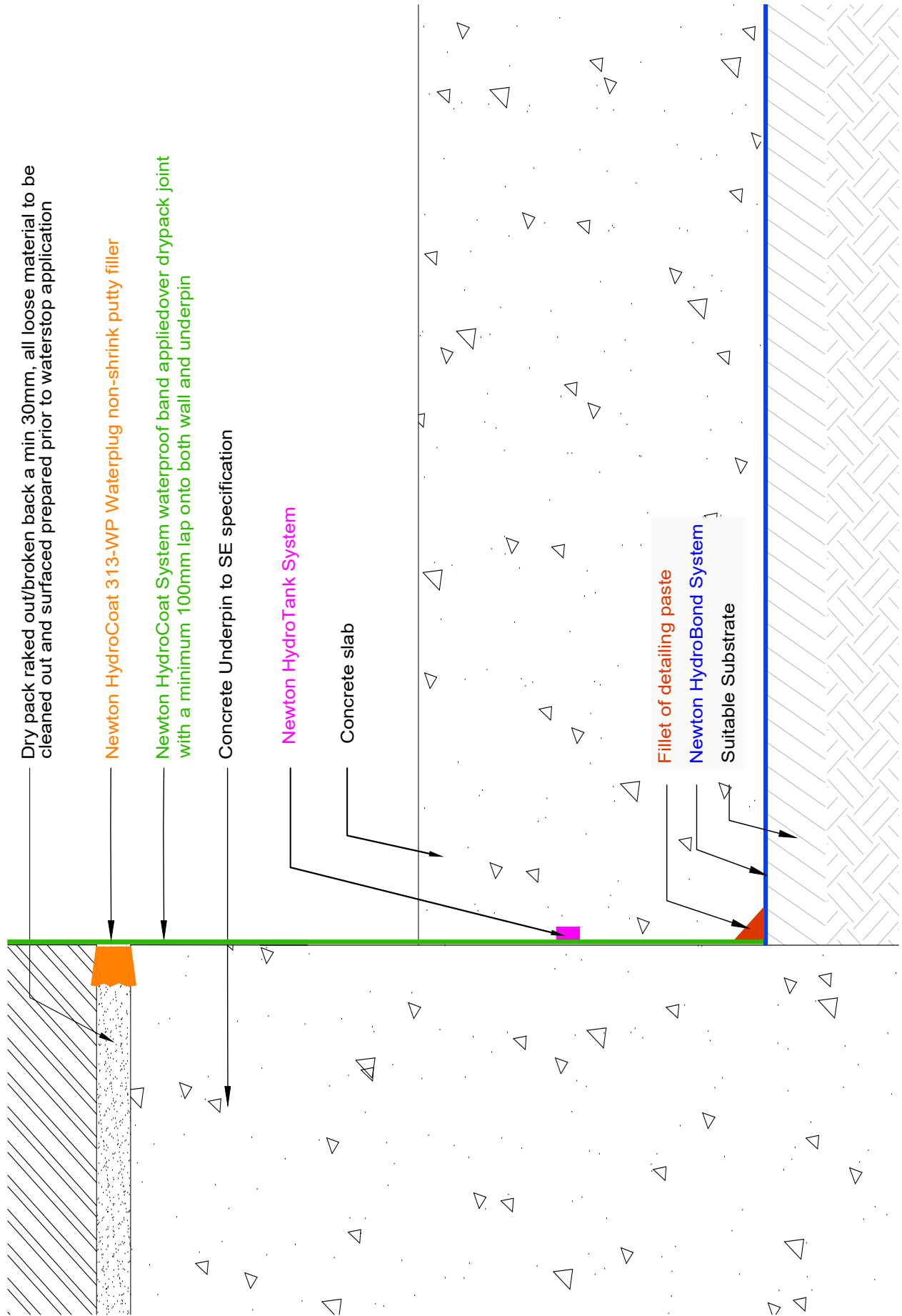

Type A Waterproofing

A-12 OUTLINE SPECIFICATION

Internal Waterproofing of Underpinning

| | |
|----------------------------------|--|
| Newton Specification Type | Structural Waterproofing. |
| Specification | A-12 |
| Description | Internal waterproofing to underpinning. No gas protection. |
| Build | Concrete underpinning, Reinforced concrete slab to BS EN 1992. |
| NEWTON HYDROTANK SOLUTION | All construction joints (day joints, shrinkage joints, movement joints etc) should be waterproofed with Newton System 300 waterbars to limit water ingress thorough joints in the structure. |
| NEWTON HYDROBOND SOLUTION | The Newton HydroBond System provides a complete and continuous waterproof barrier to the external surface of any below ground structure |
| NEWTON HYDROCOAT SOLUTION | Type A, internally applied waterproofing system. |