

# Type A & C Waterproofing

## AC-42 SPECIFICATION SHEET

### Combined Waterproofing of Hollow Block Walls on a sloping site

Rev 3.0 - 04 December 2023

#### BUILD

#### WALL CONSTRUCTION:

Hollow Block Walls

#### FLOOR CONSTRUCTION:

Block and Beam Floor

#### SITE:

Sloping

#### NWI SCALE

Waterproofing solutions can only achieve environmental Grades 1a, 1b or 2.

Refer to page 5 of the Newton Design Philosophy.

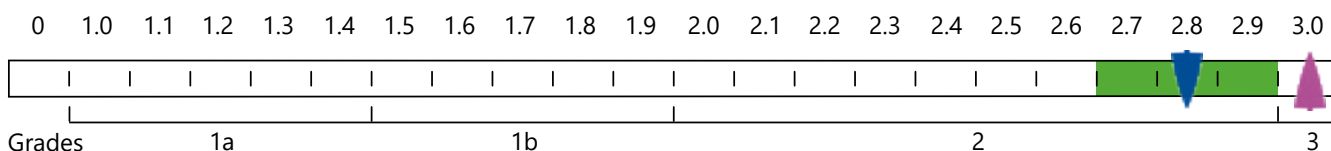

NWI Score when ventilation has not been included.



Ventilation, dehumidification or air conditioning is necessary; appropriate to intended use to achieve Grade 3 - BS 8102:2022.

This specification employs 2 forms of waterproofing (Type A - Barrier Protection) to prevent ground water passing through the structural elements of the building and (Type C - Drained Protection) to ensure that the desired internal environment is achieved. The effectiveness of the waterproofing is dependent on the Type C System being installed correctly.

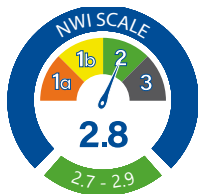

not the case we would recommend replacing the block and beam floor with a structural slab that is designed to resist water pressure as required by BS8102.

#### SPECIFICATION

#### ANCILLARIES

Install appropriate Newton waterbars to all construction joints and service penetrations.

#### TYPE A APPLIED EXTERNALLY

Waterproof the structure with [Newton HydroBond System](#) providing barrier protection.

#### TYPE C INSTALLED INTERNALLY

Waterproof internally with [Newton CDM System](#) providing drained protection.

#### SITE

The use of a block and beam floor on a retaining site is only suitable if the structure is located on a sloping site where a rising bed of water cannot exist, if this is

#### NEWTON WATERPROOFING INDEX

The Newton Waterproofing Index (NWI) is a unique scoring system that accurately assesses the level of risk and potential success of specific waterproofing specifications.

The NWI score is awarded by a panel of experienced waterproofing design specialists and reflects the chances of success of that specification. The scoring system works in conjunction with the British Standard for waterproofing, which defines the three types of internal environments as Grades 1, 2 and 3.

#### NOTES

The detailing of other building elements and termination details are available within the Newton Waterproofing specification library.

#### A-RATED INSURANCE

Tailor made insurance policies available depending on the specialist contractor and specification.

Any specification/advice provided is only valid if used with products supplied by John Newton and Company Ltd (trading as Newton Waterproofing Systems). Newton Waterproofing Systems reserve the right to update product literature at any time. Please always refer to our website for the latest versions.

# AC-42

## Combined Waterproofing of Hollow Block Walls

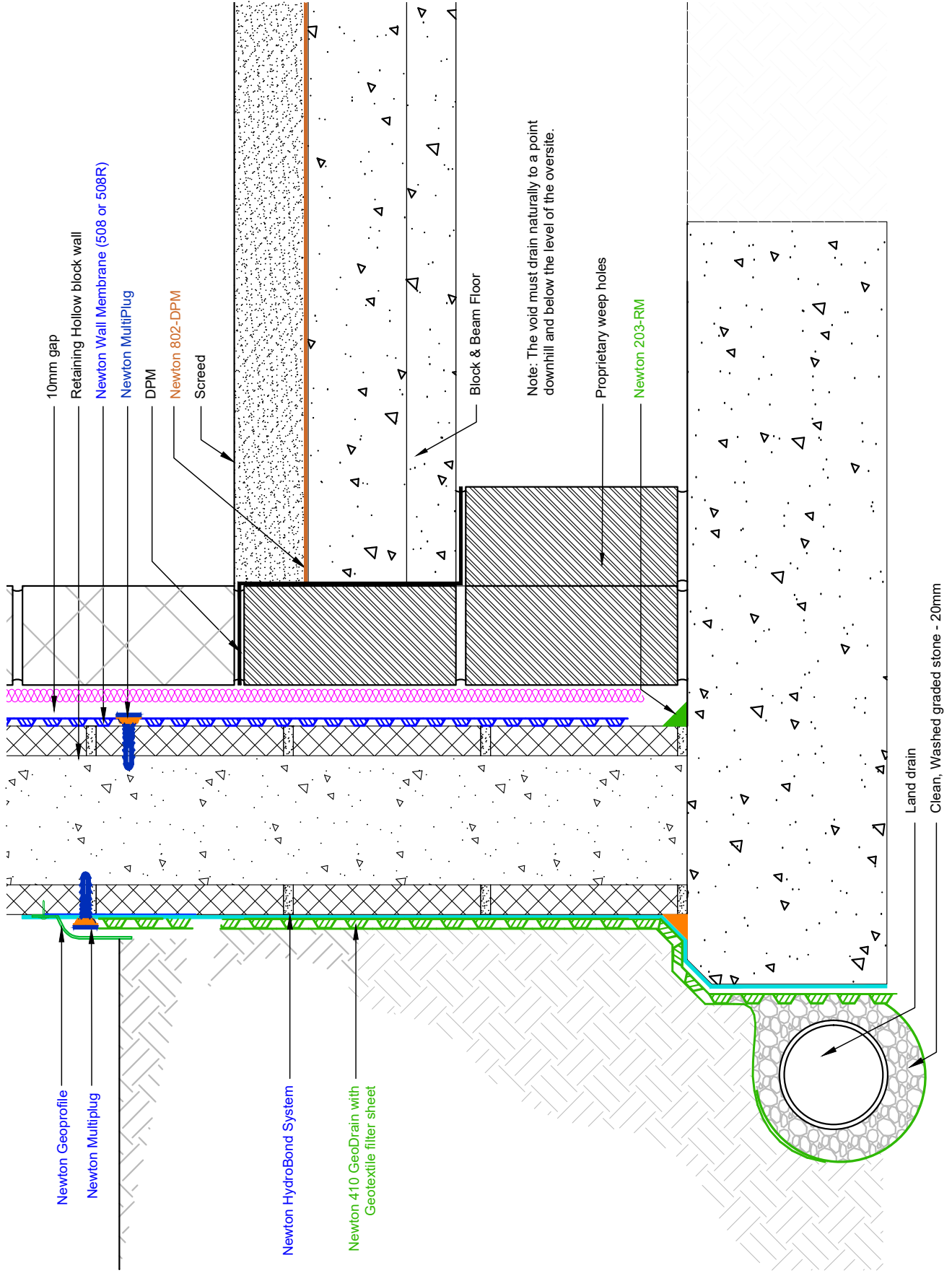

# Type A & C Waterproofing

## AC-42 SPECIFICATION OUTLINE

### Combined Waterproofing of Hollow Block Walls

NEWTON WATERPROOFING SOLUTION - AC-42

<b>Specification</b>	AC-42
<b>Description</b>	Combined waterproofing to RC structure. No gas protection.
<b>Build</b>	Hollowblock walls, with reinforced concrete core, supported from strip foundations. Block and beam floor
<b>NEWTON HYDROBOND SYSTEM</b>	<p>The Newton HydroBond System provides a waterproof barrier to the external surface of any below ground structure.</p> <p>Newton 410 GeoDrain is a two-core drainage sheet with a fully bonded non-woven geotextile filter layer</p> <p>Use of Newton 410 GeoDrain, and indeed drainage generally, is not recommended to flat sites subject to rising levels of ground water.</p>
<b>DRAINAGE</b>	The use of drainage membranes and drainage pipe are only recommended to sloping sites where the drainage medium are used to asset in the diversion around the structure of the water courses that were interrupted by the build. The drainage pipe should discharge to a point that is downhill of the property so that the water will always be moved safely by gravity.
<b>NEWTON HYDROTANK SYSTEM</b>	All construction joints (day joints, shrinkage joints, movement joints etc) should be waterproofed with <a href="#">Newton HydroTank System</a> waterbars to limit water ingress thorough joints in the structure.
<b>NEWTON CDM SYSTEM</b>	Maintainable basement waterproofing solution ideal for new-build basements and refurbishment projects. Comprises four components: Cavity Drain Membranes, Drainage, Pumps and Control Systems. Complies with the British Standard for Waterproofing.